

- 1.Material:
  - Contacts :Brass
  - Insulator:PBT+30%G.F UL94V-0
  - Shell : Brass
- 2.Mechanical:
  - Mating Force:45N max.
  - Withdrawal Force:7N min.
  - Durability:500 cycles min.
- 3.Electrical:
  - Current-max[amps] 1.0A
  - Voltage-max[volts] 30V
  - Withstanding Voltage 750V AC
  - Contact Resistance [ohms] 30 milliohms max
  - Insulation Resistance [ohms] 1000 Megohms min
- 4.Plating:
  - Contacts: Gold Flash Selective over Nickel
  - Shell:Nickel
- 5.Environmental
  - Temperature Range -55°C~+85°C

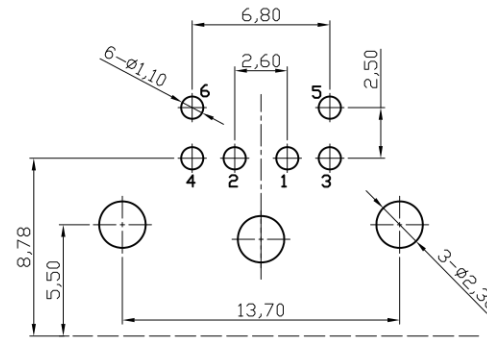
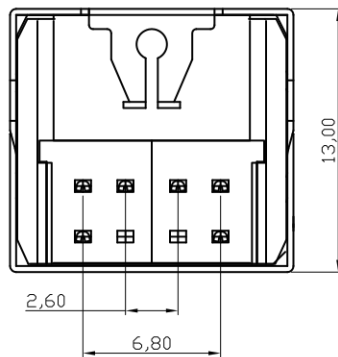

RECOMMENDED P.C.B. PATTERN LAYOUT  
TOP VIEW (TOLERANCE: ±0,05)

ASSMANN WSW P/N	HOUSING COLOR
A-DIO-FS06/GREEN	GREEN
A-DIO-FS06/PURPLE	PURPLE

**RoHS compliant**

Scale	1:1	Date		Name															
TOLERANCE		Drawn	15.07.2009	Rale															
X.X	±0.38	Approved	25.11.2010	Gerber															
X.XX	±0.25																		
X.XXX	±0.15																		
DIM	TOL	<table border="1"> <tr> <td>②</td> <td>Change the manufacture plant</td> <td>25.11.2010</td> <td>Alex</td> </tr> <tr> <td>①</td> <td>Drawn</td> <td>15.07.2009</td> <td>Rale</td> </tr> <tr> <td>Angle</td> <td>TOL</td> <td>Id.</td> <td>Modification</td> <td>Date</td> <td>Name</td> </tr> </table>				②	Change the manufacture plant	25.11.2010	Alex	①	Drawn	15.07.2009	Rale	Angle	TOL	Id.	Modification	Date	Name
②	Change the manufacture plant					25.11.2010	Alex												
①	Drawn					15.07.2009	Rale												
Angle	TOL					Id.	Modification	Date	Name										
X.°	±1°																		
X.X°	±X°																		
Angle	TOL																		



Customer-No.	
ASSMANN WSW-No. A-DIO-FS06/GREEN A-DIO-FS06/PURPLE	
Drawing-No.	
<b>ASS 3567 CO</b>	rev02
Replace	Sheet

1

2

3

4

5

6

7