

REV.	DESCRIPTION	DRAWN	CHECKED	APPROVED
A	NEW RELEASE	LJH 03/30/06'	~	LJC 09/20/05'
B	整理图面	YCH 07/27/07'	~	

NOTES:

1. MATERIAL
 - 1.1 INSULATOR:THERMOPLASTIC(UL 94V-0).
 - 1.2 CONTACT: COPPER ALLOY.
 - 1.3 CONTACT PLATED: SEE ORDERING INFORMATION.
2. SPECIFICATION
 - 2.1 TEMPERATURE: -20~+105°C.
 - 2.2 CONTACT RESISTANCE: 20mΩ max.
 - 2.3 INSULATION RESISTANCE: 1000MΩ min.
 - 2.4 DIELECTRIC WITHSTANDING VOLTAGE: AC 500V PER MINUTE.

3. PART NUMBER: DS1010
4. PRODUCT NUMBER CODE:

DS1010 - X X X X

- Central support
- S: W/ central support
- X: W/O central support
- Width dim.D
- N: 10.16mm
- W: 15.24mm
- D: 19.05mm
- Contact plating
- T1: Tin
- No.OF CONTACTS
- 24 28 30 32 40
- 42 48 52 56 64
- Series No.
- DS1010

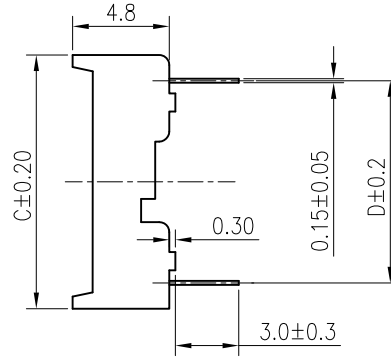

Table A:

Position	Dimension			
	A	B	C	D
24	21.34	19.56	12.65	10.16
28	24.89	23.11	12.65	10.16
30	26.67	24.89	12.65	10.16
32	27.45	26.67	12.65	10.16
40	35.56	33.78	17.73	15.24
42	37.34	35.56	17.73	15.24
48	42.67	40.89	17.73	15.24
52	46.23	44.45	17.73	15.24
56	49.78	48.01	17.73	15.24
64	56.90	55.12	21.54	19.05

