



25W Single Output Switching Power Supply

S-25 series



■ Features :

- Universal AC input / Full range
- Protections: Short circuit / Overload / Over voltage
- Cooling by free air convection
- 100% full load burn-in test
- Fixed switching frequency at 56KHz
- 2 years warranty



SPECIFICATION

| MODEL | | S-25-5 | S-25-12 | S-25-15 | S-25-24 |
|--------------------------|---|--|---------------|-----------------|---------------|
| OUTPUT | DC VOLTAGE | 5V | 12V | 15V | 24V |
| | RATED CURRENT | 5A | 2.1A | 1.7A | 1.1A |
| | CURRENT RANGE | 0 ~ 5A | 0 ~ 2.1A | 0 ~ 1.7A | 0 ~ 1.1A |
| | RATED POWER | 25W | 25.2W | 25.5W | 26.4W |
| | RIPPLE & NOISE (max.) <small>Note.2</small> | 50mVp-p | 100mVp-p | 100mVp-p | 100mVp-p |
| | VOLTAGE ADJ. RANGE | 4.75 ~ 5.5V | 10.8 ~ 13.2V | 13.5 ~ 16.5V | 21.6 ~ 26.4V |
| | VOLTAGE TOLERANCE <small>Note.3</small> | ±2.0% | ±1.0% | ±1.0% | ±1.0% |
| | LINE REGULATION | ±0.5% | ±0.5% | ±0.5% | ±0.5% |
| | LOAD REGULATION | ±1.0% | ±0.5% | ±0.5% | ±0.5% |
| | SETUP, RISE TIME | 300ms, 50ms/230VAC 800ms, 50ms/115VAC at full load | | | |
| | HOLD UP TIME (Typ.) | 90ms/230VAC 12ms/115VAC at full load | | | |
| INPUT | VOLTAGE RANGE | 85 ~ 264VAC 120 ~ 370VDC | | | |
| | FREQUENCY RANGE | 47 ~ 63Hz | | | |
| | EFFICIENCY(Typ.) | 72%/115VAC | 76%/115VAC | 77%/115VAC | 80%/115VAC |
| | AC CURRENT (Typ.) | 0.6A/115VAC 0.35A/230VAC | | | |
| | INRUSH CURRENT (Typ.) | COLD START 13A/115VAC 25A/230VAC | | | |
| | LEAKAGE CURRENT | <0.75mA / 240VAC | | | |
| PROTECTION | OVERLOAD | 105 ~ 150% rated output power Protection type : Hiccup mode, recovers automatically after fault condition is removed. | | | |
| | OVER VOLTAGE | 5.75V ~ 6.75V | 13.8V ~ 16.2V | 17.25V ~ 20.25V | 27.6V ~ 32.4V |
| | | Protection type : Hiccup mode, recovers automatically after fault condition is removed. | | | |
| ENVIRONMENT | WORKING TEMP. | -10 ~ +60℃ (Refer to "Derating Curve") | | | |
| | WORKING HUMIDITY | 20 ~ 90% RH non-condensing | | | |
| | STORAGE TEMP., HUMIDITY | -20 ~ +85℃, 10 ~ 95% RH | | | |
| | TEMP. COEFFICIENT | ±0.03%/℃ (0 ~ 50℃) | | | |
| | VIBRATION | 10 ~ 500Hz, 2G 10min./1cycle, period for 60min. each along X, Y, Z axes | | | |
| SAFETY & EMC (Note 4) | SAFETY STANDARDS | UL1012, TUV EN60950-1 approved | | | |
| | WITHSTAND VOLTAGE | I/P-O/P:3KVAC I/P-FG:1.5KVAC O/P-FG:0.5KVAC | | | |
| | ISOLATION RESISTANCE | I/P-O/P, I/P-FG, O/P-FG:100M Ohms / 500VDC / 25℃ / 70% RH | | | |
| | EMC EMISSION | Compliance to EN55022 (CISPR22) Class B, EN61000-3-2,-3 | | | |
| | EMC IMMUNITY | Compliance to EN61000-4-2,3,4,5, EN55024, light industry level, criteria A | | | |
| OTHERS | MTBF | 330.8K hrs min. MIL-HDBK-217F (25℃) | | | |
| | DIMENSION | 99*97*36mm (L*W*H) | | | |
| | PACKING | 0.39Kg; 45pcs/18Kg/0.9CUFT | | | |
| NOTE | 1. All parameters NOT specially mentioned are measured at 230VAC input, rated load and 25℃ of ambient temperature. 2. Ripple & noise are measured at 20MHz of bandwidth by using a 12" twisted pair-wire terminated with a 0.1uf & 47uf parallel capacitor. 3. Tolerance : includes set up tolerance, line regulation and load regulation. 4. The power supply is considered a component which will be installed into a final equipment. The final equipment must be re-confirmed that it still meets EMC directives. For guidance on how to perform these EMC tests, please refer to "EMI testing of component power supplies." (as available on http://www.meanwell.com) | | | | |

Mechanical Specification

Case No. 905 Unit:mm

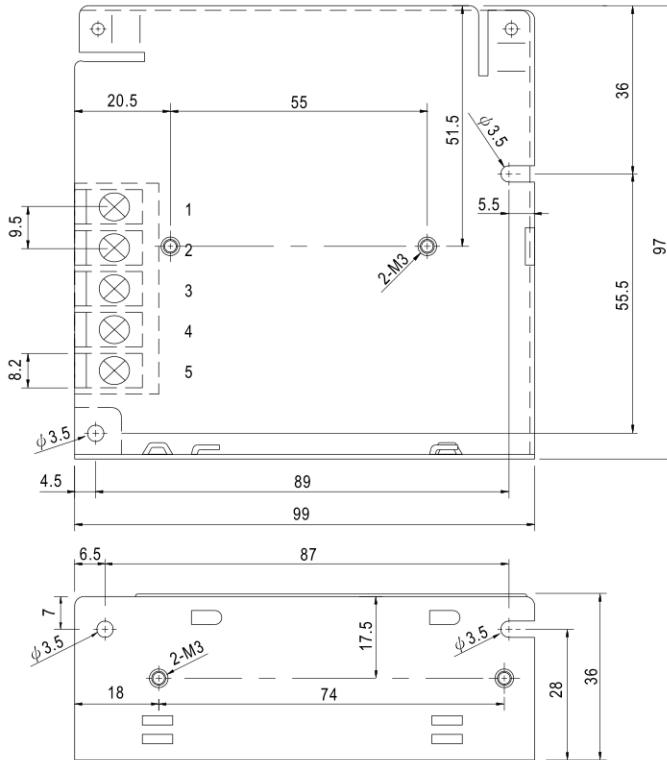

Terminal Pin No. Assignment

| Pin No. | Assignment | Pin No. | Assignment |
|---------|--------------|---------|------------|
| 1 | DC OUTPUT -V | 4 | AC/L |
| 2 | DC OUTPUT +V | 5 | AC/N |
| 3 | FG \perp | | |

Block Diagram

fosc : 56KHz

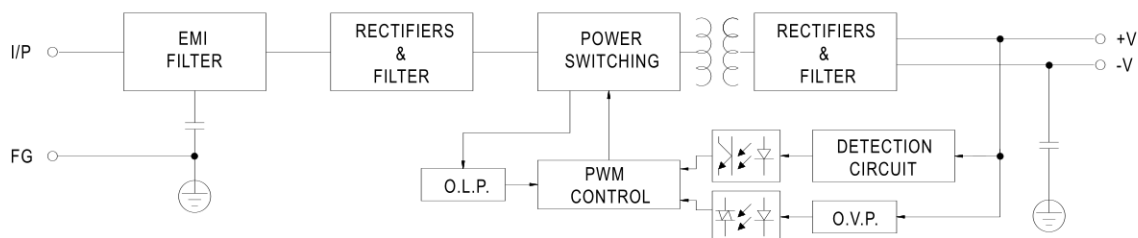

Derating Curve

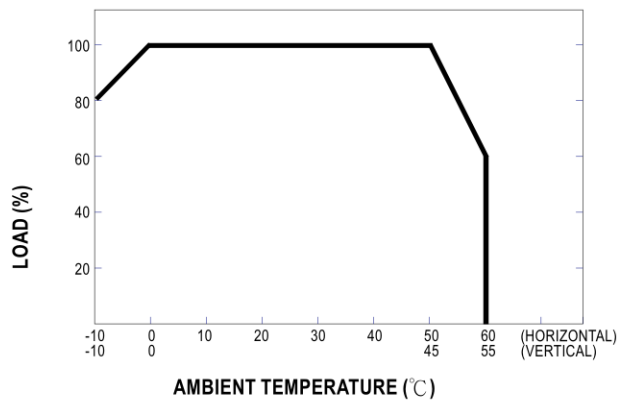

Static Characteristics (24V)

