

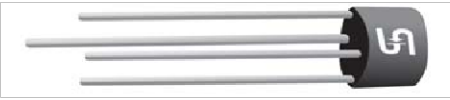

# W005GM THRU W10GM

Single Phase 1.5 AMPS. Glass Passivated Bridge Rectifiers



Voltage Range  
50 to 1000 Volts  
Current  
1.5 Amperes

## Features

- ✧ UL Recognized File # E-96005
- ✧ Glass passivated junction
- ✧ Surge overload ratings to 50 amperes peak
- ✧ Ideal for printed circuit board
- ✧ Reliable low cost construction technique results in inexpensive product
- ✧ High temperature soldering guaranteed: 260°C / 10 seconds / 0.375" ( 9.5mm ) lead length at 5 lbs. ( 2.3 Kg ) tension

## Mechanical Data

- ✧ Case: Molded plastic
- ✧ Lead: Solder plated
- ✧ Polarity: As marked
- ✧ Weight: 1.10 grams

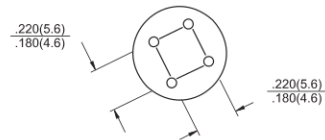
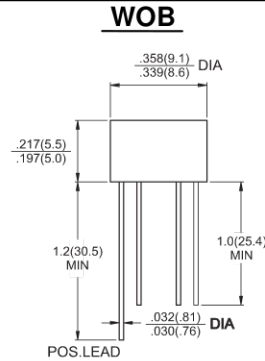

Dimensions in inches and (millimeters)

## Maximum Ratings and Electrical Characteristics

Rating at 25°C ambient temperature unless otherwise specified.

Single phase, half wave, 60 Hz, resistive or inductive load.

For capacitive load, derate current by 20%

Type Number	Symbol	W	W	W	W	W	W	W	Units
		005GM	01GM	02GM	04GM	06GM	08GM	10GM	
Maximum Recurrent Peak Reverse Voltage	V <sub>RRM</sub>	50	100	200	400	600	800	1000	V
Maximum RMS Voltage	V <sub>RMS</sub>	35	70	140	280	420	560	700	V
Maximum DC Blocking Voltage	V <sub>DC</sub>	50	100	200	400	600	800	1000	V
Maximum Average Forward Rectified Current @ T <sub>A</sub> = 50°C	I <sub>(AV)</sub>	1.5							A
Peak Forward Surge Current, 8.3 ms Single Half Sine-wave Superimposed on Rated Load (JEDEC method)	I <sub>FSM</sub>	50							A
Maximum Instantaneous Forward Voltage @ 1.5A	V <sub>F</sub>	1.0							V
Maximum DC Reverse Current @ T <sub>A</sub> =25°C at Rated DC Blocking Voltage @ T <sub>A</sub> =125°C	I <sub>R</sub>	10 500							µA µA
Typical Thermal Resistance (Note)	R <sub>θJA</sub> R <sub>θJL</sub>	36 13							°C/W
Operating Temperature Range	T <sub>J</sub>	-55 to +150							°C
Storage Temperature Range	T <sub>STG</sub>	-55 to +150							°C

Note: Thermal resistance from Junction to Ambient and from Junction to Lead Mounted on P.C.B. with 0.2" x 0.2" (5mm x 5mm) Copper Pads.

## RATINGS AND CHARACTERISTIC CURVES (W005GM THRU W10GM)

FIG.1- MAXIMUM NON-REPETITIVE FORWARD SURGE CURRENT PER BRIDGE ELEMENT

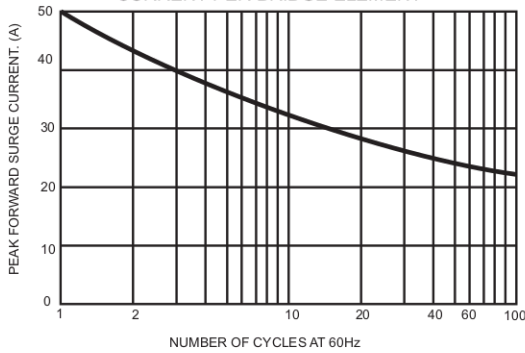

FIG.2- MAXIMUM FORWARD CURRENT DERATING CURVE

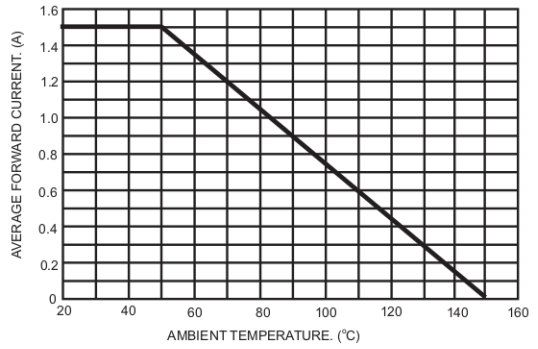

FIG.3- TYPICAL INSTANTANEOUS FORWARD CHARACTERISTICS PER BRIDGE ELEMENT

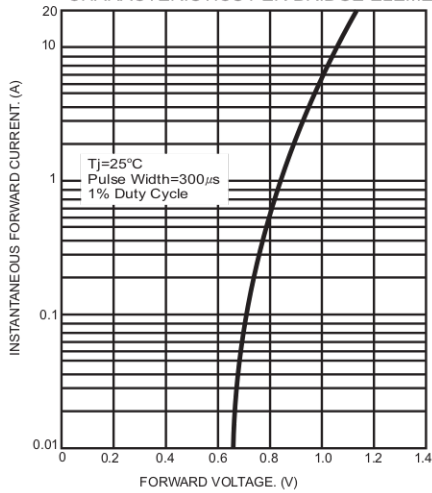

FIG.4- TYPICAL REVERSE CHARACTERISTICS PER BRIDGE ELEMENT

